

The



CARBURETTORS

FITTED TO THE

JAGUAR "3 $\frac{1}{2}$ LITRE"

(TYPE H.4. SPECIFICATION No. AUC.449)

COMMENCING ENGINE No. S.26

CEASING ENGINE No. S.3959

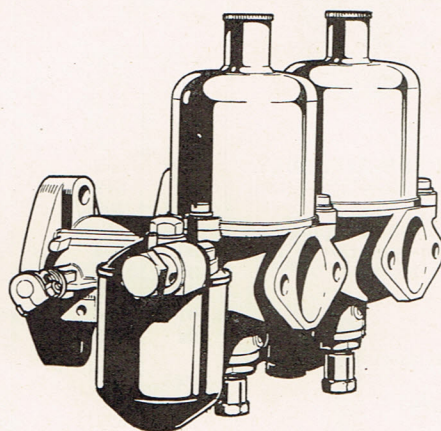

AUTHORISED DISTRIBUTOR :

HANNAN BROS. LTD.
63 FRANKLIN ST.
ADELAIDE

JAGUAR "3 1/2 LITRE". Pair of Carburetters.

Specification No. AUC.449

Illus. No.	Part No.	Qty. off	DESCRIPTION	Illus. No.	Part No.	Qty. off	DESCRIPTION
	Spec. AUC.449	1	Carburetter complete—front.				FLOAT-CHAMBER SUB-ASSEMBLY
		1	Carburetter complete—rear.				<i>—continued</i>
			BODY SUB-ASSEMBLY				
1	3266	2	Body—bare.	64	1163	2	Cap nut—brass.
			SUCTION CHAMBER AND PISTON SUB-ASSEMBLY	66	W1541/3	1	Holding-up bolt—float-chamber—front carburetter.
4	3338-P3327-3328	2	Suction chamber with piston (polished).	66A	3209	1	Holding-up bolt—float-chamber—rear carburetter.
5	AUC.8104	2	Oil cap damper assembly (4379) DN.	67	W4642/1	2	Holding-up bolt washer—copper.
10	175	4	Suction chamber securing screw.	67A	5026	2	Brass skid washer.
11	1863	4	Securing screw spring washer (2 B.A.).	67B	5027	4	Fibre washer.
12	NO61	2	Jet needle—standard.	50	130	2	Holding-up bolt washer—fibre.
13	468	2	Jet needle screw.	69	4740	1	Solenoid (12-volt) Mk. II.
			JET SUB-ASSEMBLY	69A	4795	1	End cover—solenoid.
15	3155/3157	2	Jet with head (non-operative).	N.I.	869	2	Terminal knobs.
16	113	2	Jet screw.	71	3205	1	Plunger with flat valve.
18	3158	2	Jet adjusting screw (non-operative).	72	3127	1	Compression spring—acceleration needle.
20	117	2	Jet sealing ring—brass.	73	4797	1	Stirrup—solenoid.
21	118	2	Jet sealing ring—cork.	73A	4790	1	Stirrup screw.
22	123	2	Jet copper washer—bottom half.	74	3134/8/435 AS	1	Acceleration needle (.008")—taper assembly—front carburetter.
23	3156	2	Jet bearing—bottom half.	75	3146	1	Spring for flat valve.
24	120	2	Jet gland washer—cork.	76	1453	2	Screw—2 B.A. (cheese-head).
25	3307	2	Jet gland washer—brass.	77	3003	2	Spring washer.
26	3248	2	Jet gland spring.	78	3139	1	Spring finger—adjusting screw.
27	115	2	Jet bearing—top half.	79	3128	1	Non-operative jet with plug—front carburetter.
28	122	2	Jet copper washer—top half.				THROTTLE SPINDLE, COUPLINGS AND LEVER SUB-ASSEMBLY
31	3160	2	End cap—bottom—non-operative.	80	1055	1	Washer—fibre—non-operative jet.
32	3159	2	End cap washer.				
			FLOAT-CHAMBER SUB-ASSEMBLY	81	3243	1	Throttle spindle—front carburetter.
46	1159	1	Float-chamber with stud—bare—front carburetter.	81A	3264	1	Throttle spindle—rear carburetter.
46A	3258	1	Float-chamber with bush and plug and stud—bare—non-operative—rear carburetter.	82	3116	2	Throttle disc.
47	1160	2	Float-chamber lid.	83	1358	4	Throttle disc screw.
52	1123	2	Float.	84	1380	1	Collar for return spring—split.
53	1859/1121AS	2	Float needle and seat assembly.	85	542	1	Screw for collar (4 B.A.).
55	1980	2	Float hinged lever.	89	3120/1	1	Throttle lever—fixed—rear carburetter.
56	1153	2	Float hinged lever pin.	89A	4059/2	1	Throttle lever—loose (3/8" spindle)—rear carburetter.
57	1149	2	Float tickler pin.	90	694	2	Throttle lever bolt (2 B.A.).
58	1175	2	Split pin for tickler.	37	156	2	Throttle lever bolt nut (2 B.A.).
59	1151	2	Float tickler pin spring.	38	246	2	Spring washer (2 B.A.).
60	139	2	Filter.	91	106	2	Taper pin.
61	698	2	Banjo bolt.	92	199	2	Throttle stop—front and rear carburetter.
62	695	2	Banjo union.	92A	4057	1	Offset sleeve stop (L/H)—rear carburetter.
63	141	4	Banjo bolt fibre washer.	93	521	3	Throttle stop adjusting screw.
				94	451	3	Adjusting screw spring.
				99	681	1	Throttle—flexible coupling assembly.
				101	672	4	Bolt (4 B.A.)—coupling.
				102	673	4	Nut (4 B.A.)—coupling.

Prefixes to Part Nos. indicate finish :—DN=Dull nickel plated. P=Polished outside. W=Walterised. N.I.=Not illustrated.

The original type of holding-up bolt (Part No. 1541) has a large head .92 in. across flats, and can only be used in conjunction with the cork sealing washer (Part No. 1542) which fits into a recess in the head. Holding-up bolt (Part No. 1541/3) with head .71 in. across flats is used in conjunction with a single washer (Part No. 4642 or 4642/1), or the later assembly of three special washers (Part No. 5026 (1 off) and Part No. 5027 (2 off)). If the holding-up bolts are changed it is essential to fit the correct corresponding washers.

On later-type carburetters, solenoid Mark I (Part No. 3196) assembly has been replaced by solenoid Mark II (Part No. 4740) assembly complete with stirrup and clamping screw.

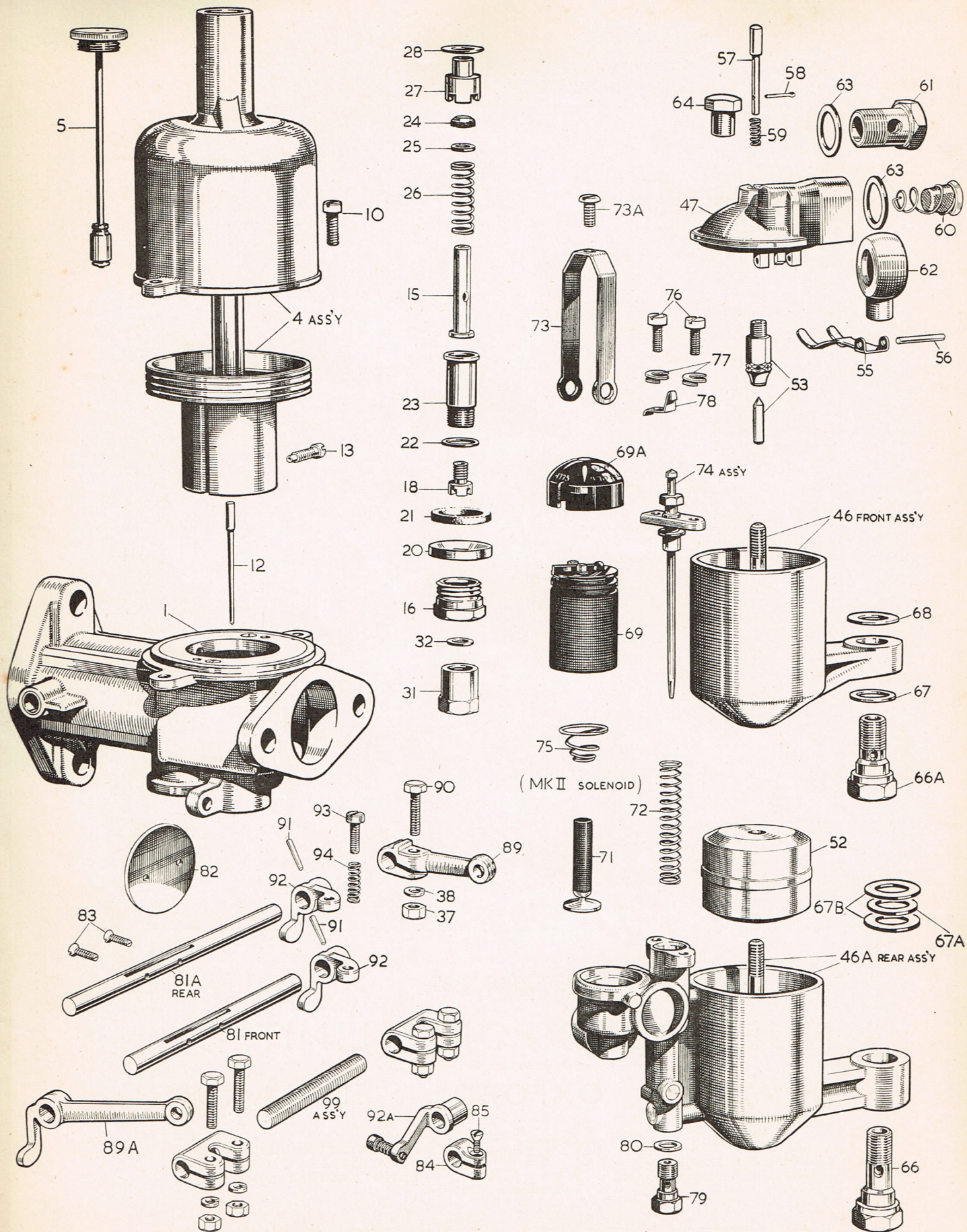

SOLE EXPORTERS:

NUFFIELD EXPORTS LIMITED

Proprietors : Morris Motors Limited

COWLEY - OXFORD - ENGLAND

Telephone : OXFORD 77733
Telex : OXFORD TELEX 77168
Telegrams and Cables : MOREX, OXFORD



Codes : BENTLEY'S, BENTLEY'S SECOND
PHRASE, A.B.C. (5th AND 6th EDITIONS),
WESTERN UNION AND PRIVATE